

TENDER DOCUMENTS

FOR

Renovation & Modification of PG
Research lab & offices, Department
of Ilmul Advia, First Floor, SUMER

JAMIA HAMDAD

HAMDARD NAGAR, NEW DELHI-62

JAMIA HAMDARD
HAMDARD NAGAR, NEW DELHI-110062
NOTICE INVITING TENDER

Date: 22/10/2021

Ref. No: JH/Civil (31)/F/M (IlmulAdvia) (Lab.)/2021

Jamia Hamdard invites sealed items rate Tenders in two bids system (Technical & Financial Bid) from Registered Contractors/Agencies at Jamia Hamdard or at Govt. /Semi Govt. Deptt./Universities/ Reputed Higher Educational Institutions. The Tender documents and other details are available on the website: www.jamiahamdard.edu. Last date of submission of the Tender 01/11/2021 up to 3.00 pm.

The bidders are also advised to visit site to satisfy themselves before submitting the bids. Bidders not fulfilling the eligibility criteria may be rejected.

NAME OF WORK: RENOVATION & MODIFICATION OF PG RESEARCH LAB & OFFICES, DEPARTMENT OF ILMUL ADVIA, FIRST FLOOR, SUMER

ESTIMATED COST: Rs. 10, 80,718.00

EARNEST MONEY: Rs 21,650.00

TENDER COST: Rs. 600 only (Non Refundable)

TIME PERIOD: 45 days.

The Tender duly filled should be dropped in the Tender Box kept in Purchase Section on or before 01/11/2021 up to 3.00 PM along with demand draft of Earnest money & Tender fee in sealed envelope clearly specifying the name of work. The D.Ds shall be in favour of "Jamia Hamdard" payable at New Delhi. The Tender shall be opened on 01/11/2021 at 3.30 PM by the tender committee in the presence of available interested parties in the Office of Executive Engineer and the Financial bid of the eligible parties will be opened after due information to eligible parties.

In case the required procedure is not followed, the tender can be rejected. Jamia Hamdard reserves the right to reject any or all tenders or split the tenders without assigning any reason whatsoever.

Registrar

Copy to:

1. System Analyst, Computer Center, to kindly upload the NIT with tender documents on the University's website.
2. PA to Finance Officer for kind information
3. Executive Engineer for kind information
4. HoD, Department of Ilmul Advia.
5. Notice board of Admin. Block
6. Concerned AE(Civil & Electrical) for necessary action

(2) **SCOPE OF WORK**

- Renovation & Modification of PG Research lab & offices, Department of Ilmul Advia, first floor, SUMER
- False Ceiling work as per BOQ
- Aluminium work as per BOQ
- PVC Flooring as per BOQ

(3) **ELIGIBILITY CRITERIA**

- The agency must have completed 3 similar works in Last Three years in Govt./ Semi Govt. Deptt./Universities/ Reputed Higher Educational Institutions.

Copy of work /purchase order or contract / Completion Certificate/ satisfactory report from Client, duly attested by bidder should be enclosed along with the Technical Bid.

- The bidder should be a single Company. No consortium is allowed.
- The firm should have average annual financial turnover of at least Rs. 25 Lakhs during the preceding last 3 consecutive financial years. Copies of the audited balance sheet of the vendor/bidder for the last three financial years, details of Permanent Account Number and ITR (Income Tax Return) for last 3 financial years must be attached by the Bidder.
- The Bidders must have G.S.T & PAN No., ESI, EPFO, company website and other necessary registrations.

(4) **SUBMISSION OF BIDS**

1. Submission of Tender: Tenders should be submitted in two Parts i.e. “Technical bid” (Part-A) and “Price bid” (Part-B) in two separate sealed envelopes. Both the parts should be further put in a single sealed envelope super-scribing NIT No. & name of work, due date for opening, bidder’s name & address. The tender duly filled should be dropped in the tender box kept in the Purchase Section; It should not be handed over to any employee of the Jamia Hamdard. No tender shall be accepted later than the time schedule specified above. Any clarifications/amendments/corrigenda etc., to NIT before last date of submission of bid will only be available on our website: www.jamiahamdard.edu. Therefore bidders are advised to keep visiting our website.

Technical Bid (Part-A):

In this bid, the bidder shall submit the following:

- a. Covering letter on Company’s Letter head
- b. Bio data of company (Company profile, organizational setup, credentials, list of plant, machinery & tools in his possession).
- c. Earnest Money Deposit.
- d. Copies of GST no., PAN no., ESI, EPFO Registration etc.

- e. Net worth Certificate of Rs. 5 Lakhs certified by Chartered Accountant.
- f. Company's financial performance documents (Audited balance sheet, and profit and loss statement)
- g. Copies of work orders for similar nature of works of at least one contract of 80% value of estimated cost of works or two contracts of similar nature of works of 60% value of estimated cost of works or three contacts of similar natures of works of 40% value of estimated cost of works in the last 3 years.
- h. Entire NIT (except Price bid) duly signed & stamped by the bidder.
- i. Experience of having successfully completed works during the last 3 years ending last day of the month previous to the one in which applications are invited.
- j. Average annual financial turn over on said work should be at least 25 Lakhs during the last 3 financial years. Documents in support should be attached.

Note

1. Completion certificate submitted should be by an officer not below the rank of Executive Engineer.
2. All documents submitted by the bidder should be self-attested along with stamp

Price Bid (Part-B):

- i. BOQ of Civil Engineering Works is cited on **Annexure "X"**

In this bid, the related works' bidders are required to quote his item rates in the above said attached BOQ in accordance with the scope of works, terms & conditions & technical specifications enclosed. The rates/price quoted by contractor should be all inclusive i.e. should include all material cost, labour, services, plant/machinery/tools & tackles, ladders & scaffolding required for work, freight, Insurance, Octroi, Govt. duties & levies, GST, Service Tax, Sales Tax etc.), transport/cartage of materials/labour and all other expenses not specifically mentioned but reasonably implied. Nothing over and above these rates shall be payable to contractor. Further nothing extra in rates will be considered for any variations in tender quantities or due to any site difficulties. It is mandatory for bidder to quote all items rate as asked for in the BOQ/ PRICE schedule. Failure in not filling some item rates will lead to rejection of tender. The bidders should quote unconditional rates, neatly written without any overwriting and all pages should be duly signed & stamped.

5 GENERAL TERMS & CONDITIONS

- I. **Earnest Money:** An earnest money of **Rs. 21,650.00** for the Civil Engineering works have to be enclosed along with the Technical bid (Part-A). The EMD shall only be in the form of Bank Draft in favour of Jamia Hamdard, New Delhi. No Cheques/Cash shall be accepted as EMD. The refund of EMD to the technically disqualified shall be made within 15 days from the date of opening of price bid. The EMD of the successful lowest bidder (L1) shall be held back and will be released after completion of the works and site clearance.

- II. **Validity of Tender:** Tender shall be valid for our acceptance without any change in rates and NIT conditions for a period of 90 days from the date of opening of price bid.
- III. **Escalation:** No escalation over and above items rates quoted by the bidder shall be paid during the execution of contract.
- IV. **Completion time:** The time shall be the essence of this contract and entire work as titled above is to be completed in all respects within a period of two 45 Days from the date of issue of the work order. Any delay in completing the work for reasons attributable to the Contractor is liable for liquidated damages as per clause XIII of NIT. Under the force-majeure conditions or delay due to reasons beyond control of the contractor, Jamia Hamdard may grant suitable time extension without penalty for which the contractor has to request along with the justification/ reasons well in advance to Jamia Hamdard for approval without any prejudice to price escalation. No time extension request shall be considered after the expiry of completion period/contract. The decision of Executive Engineer (E & M) regarding Time extension will be final and binding on the contractor.
- V. The rates shall be inclusive of all taxes (Service Tax, GST etc.) duties and cartage etc. Jamia Hamdard welfare Relief Fund will be deducted @ 0.25% of the amount of total bill claimed.
- VI. **Deviations:** No deviation from the stipulated terms and conditions will be allowed. Tender will be unconditional.
- VII. **Site Conditions:** Contractor shall acquaint himself fully with the site conditions and the working environment of Jamia Hamdard before quoting his rates. No Compensation on account of any site difficulties will be entertained, at a later date, after award of the work.
- VIII. Before tendering, the Contractor shall visit and examine the site and satisfy himself as to the site conditions, the correct dimensions of the work and facilities. In case of any doubt, may be clarified from the office of the Assistant Engineer (Civil)
- IX. **Correspondence:** All the correspondence in respect of tender/award of work shall be made to Executive Engineer (E & M).
- X. **Terms of Payment:** The payment shall be made on submission of the bills in proper format by the contractor after due certification by the engineer responsible for supervision of the work. Contractor can submit two interim or running bills and one final bill after completion of work for claiming payment based on actual quantities of items of work executed as per BOQ and Engineer's instructions. 5% deductions will be made towards the security deposit from each running bill. The security deposit shall only be refunded after expiry of the defect & liability period.
- XI. **Labour Laws:** The contractor will abide by all the rules and regulations related to labour laws, accident, workmen compensation act, workmen insurance etc. This will be the sole responsibility of the contractor. Jamia Hamdard will not be a party at any stage in any of the disputes relating to the above. In case, Jamia Hamdard has to bear any expenditure due to non-conformance of the above provisions by the contractor, the same will be recovered from contractor's bills.
- XII. Rules governing the Contractor's employees working in the Jamia Hamdard Premises: The contractor's employees working inside the Jamia Hamdard campus will abide by the Centre's rules & regulations for works inside the campus. Any damage to the

Jamia Hamdard property due to mishandling, carelessness on the contractor's or his workmen's part will be recoverable from the contractor's bills.

- XIII. **Liquidated damages:** In case the work is delayed beyond the specified completion period for reasons attributable to the contractor, deductions on account of Liquidated damages @0.5% of the contract value per week will be deducted subject to a maximum of 5% of the contract value. However, during the delayed period, Jamia Hamdard also reserves the right to get some portion of work done by any other contractor at the risk and cost of the existing contractor and amount to that effect along with 10% overhead charges will be deductible from his bills/dues.
- XIV. **Extra or substituted item:** If any extra or substituted item appears in the work, contractor shall submit its rate analysis supported with documents which shall be approved by Engineering Department. Analysis of rates will be based on DSR document of CPWD or based on market rates for determining item rate and pay to contractor accordingly.
- XV. **Defect Liability period:** Defect liability period shall be six (6) month from the date of completion of work. Any defect arising in this period due to contractor's fault will be rectified by him at his own cost. Failure to do so, shall lead to forfeiture of security deposit.
- XVI. **Security Deposit:** A security deposit equal to 05 % of the value of work will be deducted from Contractor's bills and shall be refunded after the completion of defect liability period of six month after ensuring successful performance of the system executed by the contractor.
- XVII. Contractor should depute a qualified supervisor dedicated for this work, who will monitor and coordinate the works from contractor's side and interact with the Jamia Hamdard Engineers, responsible for supervision of work, on regular basis.
- XVIII. Contractor will take due permission for entry of all his workmen in Jamia Hamdard. No unauthorized person will be allowed to work inside.
- XIX. The contractor will arrange all necessary materials, tools, equipment, access ladders & scaffolding, measuring instruments and working consumables etc. needed for execution of the works. Safe custody of all such material will be contractor's sole responsibility. No extra charges will be paid for the same. Watch and ward of all material till the system is taken over by Jamia Hamdard shall be the sole responsibility of the contractor and pilferage etc. shall be entirely to his account.
- XX. During execution of work, Engineer can make minor changes in the scope of work as per site conditions or other reasons. Contractor will have no extra claim in his rates for the same.
- XXI. If during the execution of works, any damage is caused to Jamia Hamdard property by contractor's/contractors' workers, contractor will duly make good the loss. Jamia Hamdard has the right to make suitable deduction from contractor's bills along with penalty, if contractor fails to make good the loss.
- XXII. During execution of work, the contractor/contractors should follow all standard norms of safety measures/precautions as per relevant IS codes and CPWD specifications to avoid accidents/damages to man, machines and buildings, at his own cost. Contractor will have his own arrangement to escort the labour to the nearest hospital for treatment in case any injury happens to any worker during execution of work.

- XXIII. Manpower deployed by the contractor at our site for carrying out contract works is strictly prohibited being associated with any other works on the campus.
- XXIV. No material belonging to the contractor whether consumable or non-consumable should be brought inside the Jamia Hamdard campus without proper entry at the Main Gate nor any material should be taken out without proper gate pass issued by the authorized representatives of the Centre.
- XXV. During execution of the work, contractor should dispose off waste material on regular basis and should keep the area of work properly cordoned off and neat and clean as far as possible. After completion of work, contractor should clear the site completely of all unwanted and junk material before submitting his final bill.
- XXVI. Jamia Hamdard will provide electricity, if needed, the electrical energy meter will be provided by the contractor and necessary deduction will be made as per the actual consumption of electricity during execution of work. The contractor has to make his own arrangements for water.
- XXVII. Tender once submitted will remain with the Jamia Hamdard and will not be returned to the bidders.
- XXVIII. **Termination of Contract:** The Jamia Hamdard reserve the right to terminate the contract on account of poor workmanship, failure to mobilize site within 15 days, non-compliance of specifications for the works, abnormal delay in progress of work, violation of any contract provisions by the contractor. In such case, contractor's EMD and security deposit deducted so far will be forfeited.
- XXIX. The contract can also be terminated on the request of contractor. In such cases the contractor is liable to pay Liquidated damages @ 5% of tendered value besides forfeiture of EMD & security deposit recovered so far.
- XXX. Any dispute arising out of this contract will be subjected to jurisdiction of New Delhi/Delhi.
- XXXI. Tenders not complying with any of the provisions stated in this tender document are liable to be rejected. Jamia Hamdard also reserves the right to accept or reject any or all the tenders without assigning any reason and does not bind himself to accept the lowest tender or split the work in two or three parts.
- XXXII. That in the event of any difference, or dispute arising between the parties to this Agreement for any reasons whatsoever relating to the contract, whether during the substance of this Agreement or their after, it has specifically been agreed that the party will endeavor to amicably resolve the difference, but in case if dispute or differences still remain unresolved, the same shall be referred to the sole Arbitrator appointed by the Vice Chancellor of Jamia Hamdard and the Arbitrator decision shall be final and binding upon the parties concerned.

(6) SPECIAL TERMS AND CONDITIONS

- I. Makes of Items to be used by contractor will be according to the list of approved makes given. No other makes will be used by the contractor.
- II. Contractor will first submit the sample of relevant make to Executive Engineer (E&M) for approval before procuring the material.

- III. Contractor will arrange proper necessary material at his own cost and will take all safety measures like safety belts, extra labour to hold ladders etc. If it is observed that work is proceeding without adequate safety precautions, work may be stopped by Engineer in-charge and in such cases, contractor will be solely responsible for delay and its consequences thereof.

(7) TECHNICAL SPECIFICATIONS

As per CPWD Specifications and attached BOQ.

(8) CHECK LIST

TO BE SUBMITTED ALONG WITH BID

The tenderers are requested to ensure the submission of the essential documents to avoid disqualification of the bid. However, the check list is not exhaustive and the tenderer are requested to go through to NIT & related documents carefully and completely for fulfillments of tenderers requirement.

S. No.	Enclosures	Submitted
1.	Cost of tender document	
2.	EMD	
3.	Similar works order	
4.	Annual turnover certificate for the last three years with certification from practicing chartered accountant	
5.	Copy of registration letter	
6.	Signature with stamp in all pages of tender documents.	
7.	Bank account detail	
8.	E-mail address	
9.	Address for communication	
10.	Phone no, Mobile no, Landline no.	

Signature of the Tenderers

ANNEXURE-"B"

(9) LIST OF APPROVED MAKES (Civil Works)

1.	Ordinary Portland Cement	L&T, Ultra Tech, ACC, or other brands approved by the Engineer in-charge
2.	Steel Reinforcement Bars	TISCO, SAIL, RINL, Rathi udyog Ltd.
3.	Structural Steel Sections	TISCO, SAIL RINL, Supreme....
4.	Stone Aggregate (Blue/Black)	Sohna, Pali or other Approved
5.	Water proof Shuttering	Century, Green, Duro/Haryana Plywood
6.	Vitrified flooring and wall tiles	Kajaria, Orient, Somany, or equivalent as approved by the Engineer in-charge.
7.	Exterior Paint	Apex (Asian), weather shield (ICI DULUX) Shalimar or equivalent as approved by the Engineer in-charge.
8.	White Cement	Birla, JK Cement
9.	Waterproofing	Structural Water proofing Co. Dr. Fixit, Overseas Water Proofing
10.	Silicon Sealants	Dow Corning.GE
11.	Glass and mirror	Saint Gobain/Guardian/Asahi
12.	The Adhesives	Weber, Lafarge, Keisel, Balendura
13.	Expansion joint covers	CS, Inpro
14.	Glass	Saint Gobain, Guardian, Glaverbel,
15.	Gypsum board	Gyp pro, Lafarge or equivalent.
16.	Calcium silicate false ceiling	Armstrong or equivalent.
17.	CPVC pipes	Astral, Supreme or equivalent.
18.	S.S. sink	Neelkhant or equivalent.
19.	Aluminum	Jindal Or equivalent
20.	Commercial board and ply	Bhutan/Century/Greenlam, ISI approved brand or equivalent as approved by Engineer In-charge.
21.	Chequered Tiles and interlocking Paver Block, Kerb Stone	Hindustan, Modern, KGS, Nitco, or equivalent as approved by the Engineer in-charge.
22.	MDF Board	Century/Greenlam or equivalent

LIST OF APPROVED MAKE FOR ELECTRICAL WORKS

SPECIFICATION OF MATERIAL

S. No.	Particulars	Make
1.	Cable / Wire	Havells/ Polycab / Finolex/RR Kabel
2.	LED Light / LED Tube Light	Crompton Greaves / Havells / Philips
3.	MCB/Isolator /MCCB	ABB/ L&T/Havells
4.	Distribution Box	ABB/ L&T/Havells
5.	PVC conduits/ casing capping	Setia/Plasoduct/AKG
6.	Exhaust Fan / Wall Fan / Ceiling Fan	Crompton Greaves / Havells
7.	Switch / Socket	Anchor Roma / Havells

(Signature of bidder)

Note:-Contractors are requested to read the complete tender documents and visit the site before submission of Bids.

ANNEXURE-"X"

Bill of Quantities					
Name of Work - Renovation & Modification of Research lab & offices, Department of Ilmu Advia, First Floor, SUMER					
S.No	Description of work	Qty	Unit	Rate	Amount
	Civil Work				
1	Demolishing brick work manually/ by mechanical means including stacking of serviceable material and disposal of unserviceable material within the campus premises as per the direction of Engineer In- charge In cement mortar	12.00	cum		
2	Dismantling doors, windows and clerestory windows (steel or wood) shutter including chowkhats, architrave, holdfasts etc. complete and stacking within the campus premises as per the direction of Engineer In- charge Of area beyond 3 sq. metres	7.00	each		
3	Demolishing R.C.C. work manually/ by mechanical means including stacking of steel bars and disposal of unserviceable material within the campus premises as per the direction of Engineer In- charge (in counter)	3.50	cum		
4	Dismantling old plaster or skirting raking out joints and cleaning the surface for plaster including disposal of rubbish to the dumping ground within within the campus premises as per the direction of Engineer In- charge	10.00	sqm		
5	Disposal of building rubbish / malba / similar unserviceable, dismantled or waste materials by mechanical means, including loading, transporting, unloading within the campus premises dumping ground or as approved by Engineer-in-charge, beyond 50 m initial lead, for all leads including all lifts involved.	25.00	cum		
6	Extra for cutting reinforcement bars manually/ by mechanical means in R.C.C. or R.B. work (Payment shall be made on the cross sectional area of R.C.C. or R.B. work) as per direction of Engineer in-charge.	2.00	sqm		
7	Extra for scrapping, cleaning and straightening reinforcement from R.C.C. or R.B. work.	105.00	kg		

8	Dismantling G.I. pipes (external work) including excavation and refilling trenches after taking out the pipes, manually/ by mechanical means including stacking of pipes within the campus premises as per direction of Engineer-in-charge : 15 mm to 40 mm nominal bore	30.00	metre		
9	Removing & refixing of wooden open racks with required modification including other materials i.e. plyboard, fitting fixtures, painting/polishing etc as per site requirement and direction of Engineer In- charge	150.00	Sqft		
10	Removing & dismantling of wooden shutters below the counter etc manually or mechanically, and disposal/stacking of the same within the campus premises as per the direction of Engineer In-charge	250.00	Sqt		
11	Removing & dismantling of iron glazed window etc manually or mechanically, and disposal/stacking of the same within the campus premises as per the direction of Engineer In- charge	360.00	Sqft		
12	Half brick masonry with common burnt clay F.P.S. (non modular) bricks of class designation 7.5 in superstructure above plinth level up to floor V level. Cement mortar 1:4 (1 cement :4 coarse sand)	30.00	sqm		
13	12 mm cement plaster of mix : 1:4 (1 cement: 4 fine sand)	42.00	sqm		
14	15 mm cement plaster on rough side of single or half brick wall of mix: 1:4 (1 cement: 4 fine sand)	30.00	sqm		
15	Providing and fixing Ist quality ceramic glazed wall tiles conforming to IS: 15622 (thickness to be specified by the manufacturer), of approved make, in all colours, shades except burgundy, bottle green, black of any size as approved by Engineer-in-Charge, in skirting, risers of steps and dados, over 12 mm thick bed of cement mortar 1:3 (1 cement : 3 coarse sand) and jointing with grey cement slurry @ 3.3kg per sqm, including pointing in white cement mixed with pigment of matching shade complete.	15.00	sqm		
16	Providing and laying in position cement concrete of specified grade excluding the cost of centering and shuttering - All work up to plinth level 1:3:6 (1 Cement : 3 coarse sand (zone-III) : 6 graded stone aggregate 20 mm nominal size)	0.50	cum		

17	Anti termite treatment with injecting of solution, drilling holes of 10-20cm deep at every 60cm along the walls in the floor for injecting chlorpyrifos 20% E.C. of ISI marked in the labs & offices complete as required. (floor area shall be measure for payment)	150.00	Sqm		
18	Providing & fixing the PVC flooring of 1.5mm thick of approved quality & make of Poly floor/Wonder Floor in required shade and color (as per approved sample). The PVC flooring shall be fixed with required approved quality of rubber adhesive etc. complete.	1100.00	Sqft		
	Plumbing Work		.		
19	Providing and fixing white vitreous china laboratory sink with C.I. brackets, C.P. brass chain with rubber plug, 40 mm C.P brass waste and 40mm C.P. brass trap with necessary C.P. brass unions complete, including painting of fittings and brackets, cutting and making good the wall wherever required : Size 450x300x150 mm	2.00	each		
20	Providing and fixing unplasticised PVC connection pipe with brass unions : 45 cm length 20 mm nominal bore	6.00	each		
21	Providing and fixing P.V.C. waste pipe for sink or wash basin including P.V.C. waste fittings complete. Flexible pipe 40 mm dia	2.00	each		
22	Providing and fixing PTMT grating of approved quality and colour. Circular type 125 mm nominal dia with 25 mm waste hole	2.00	each		
23	Providing and fixing C.P. brass angle valve for basin mixer and geyser points of approved quality conforming to IS:8931 15mm nominal bore	4.00	each		
24	Providing and fixing Chlorinated Polyvinyl Chloride (CPVC) pipes, having thermal stability for hot & cold water supply, including all CPVC plain & brass threaded fittings, i/c fixing the pipe with clamps at 1.00 m spacing. This includes jointing of pipes & fittings with one step CPVC solvent cement and the cost of cutting chases and making good the same including testing of joints complete as per direction of Engineer in Charge. Concealed work, including cutting chases and making good the walls etc. 20 mm nominal outer dia Pipes	12.00	metre		
25	Providing and fixing 3" dia 6 kg pressure PVC pipe for drainage line and stake line (Prakash make)	15.00	metre		

26	Providing and fixing 3" dia 6 kg pressure PVC Bend/Tee in drainage PVC line (Prakash make)	3.00	each		
27	Providing and fixing of nanny trap of size 100mm	4.00	each		
28	Providing and fixing of heavy C.P. Brass swan neck of nozzle type which opens three way for the laboratory purpose	3.00	each		
29	Repair of windows by cutting and making serviceable by welding	1.00	L.S.		
	Aluminium partition Work				
30	Providing and fixing the aluminum partitions with extruded built up standard tubular sections of size 2.5"x1.5" of 16 gauge. the door section of outer frame is 3.25"x1.75" and top & lock rail 3.25"x1.75" of 16 gauge and bottom rail rail of size 4.25"x1.75" of 16 gauge of dark champagne color, fixing with dash fasteners of required dia and size, including necessary filling up the gaps at junctions i.e at top ,bottom and sides with required EPDM rubber/neoprene gasket etc .Aluminium sections shall be smooth ,rust free, straight, mitered and jointed mechanically wherever required including cleat angle, Aluminium snap beading for glazing /paneling ,c.p brass/stainless steel screws, all necessary fittings, fixtures, handles, tower bolts, locks, aluminium angle beading, rubber etc. all complete as per the direction of Engineer in charge. The partition having the 5mm thick plain glass on bottom of the door 12 mm thick laminated particle board of approved color complete as required/as existing.	380.00	Sqft		
31	Providing and fixing aluminium die cast body tubular type universal hydraulic door closer (having brand logo with ISI, IS : 3564, embossed on the body, door weight upto 35 kg and door width upto 700 mm), with necessary accessories and screws etc. complete.	2.00	each		
	Wooden Workstation				

32	Providing and making wooden counter with black granite top fixed over the teak wood frame of size 2"x2.5" with intermediate members where as required of required size, counter size of 6(L)'x3'(h)x4'(w) with 2 numbers of cabinet with drawers & shutters each side of counter covered with using 19mm thick commercial plyboard with Intermediate shelves as per drawing with the provision for fixing of open reagent rack on the top & center of the counter, Including Teak wood moulding, piano hinges, telescopic channel, handle, knob, magnetic catcher, lock, 6" SS shoe, 1mm thick lamination of approved brand on exposed surfaces whereas required and polishing/painting on internal surfaces, with two or more coat of anti termite solution on all surfaces & black granite top with edge moulding, etc. complete. (Front area of one side of the counter shall be measured for payment)	72.00	Sqft		
33	Providing and making wooden shutters with 1st class marandi wooden outer & inner frame of size 2.5"x1.5" with Intermediate wooden ply board(19mm) shelves of required sizes and door shutters as per drawing with laminated sheet of 1mm thick of Greenlam/Marino on outer surface. Including Teak wood beading, chapka & kunda, magnetic catcher, piano hinges, fancy handle synthetic enamel paint with primer and putty on internal surface, and hardware complete.	170.00	Sqft		
34	Providing, making & fixing wooden open reagent rack over the workstation counter of size 5'(L)x2'(h)x16" (w), with wooden plyboard of 19mm thick with one partition and top & middle shelves including 1mm thick lamination on sides as per drawing Including Teak wood beading, with putty, primer & synthetic enamel paint on internal surface, and hardware complete.	40.00	Sqft		
	Painting, white wash & plaster in patchwork				
35	Removing dry or oil bound distemper, water proofing cement paint and the like by scrapping, sand papering and preparing the surface smooth including necessary repairs to scratches etc. complete.	1165.00	sqm		

36	Applying one coat of water thinnable cement primer of approved brand and manufacture on wall surface : Water thinnable cement primer	240.00	Sqm		
37	Providing and applying white cement based putty of average thickness 1 mm, of approved brand and manufacturer, over the plastered wall surface to prepare the surface even and smooth complete.	240.00	sqm		
38	Distemping with 1st quality acrylic distemper (Ready mix) having VOC content less than 50 grams/ liter of approved brand and manufacture to give an even shade : upto al height including jhoola etc.				
a/	Old work (two or more coats)	945.00	sqm		
b	New work (three or more coats)	220.00	sqm		
39	Painting with synthetic enamel paint of approved brand and manufacture of required colour to give an even shade :upto al height including jhoola etc.				
a	Old work(two or more coats)	200.00	sqm		
b	New work(three or more coats)	22.00	sqm		
40	Repairs to plaster of thickness 12 mm to 20 mm in patches of area 2.5 sq.meters and under, including cutting the patch in proper shape, raking out joints and preparing and plastering the surface of the walls complete, including disposal of rubbish to the dumping ground, all complete as per direction of Engineer-in-Charge including necessary T&P and centring & shuttering and scaffolding up to all requirment high of the buildings.	30.00	Sqm		
	Total				
	Total in Words				

(Signature of the Contractor & Stamp)

Bill of Quantities of Electrical Work

BOQ for the S/I/T/C of Sub main Circuit wiring, MCBs, DBs, Fitting & Fixtures etc for labs and offices of D/o Ilm ul Advia, First Floor, SUMER, Jamia Hamdard, Hamdard Nagar, New Delhi

S.No.	Particular	Qty	Unit	Rate	Amount
1	Wiring for light point/ fan point/ exhaust fan point/ call bell point with 1.5 sq.mm FRLS PVC insulated copper conductor single core cable in surface / recessed medium class PVC conduit, with modular switch, modular plate, suitable GI box and earthing the point with 1.5 sq.mm FRLS PVC insulated copper conductor single core cable etc. as required (Make: Havells/ Polycab / Finolex)	17	Nos.		
2	Supplying and fixing of following sub-main circuit wiring with PVC insulated copper conductor alongwith loop earthing single core cable and laying in PVC Conduit/casing, capping on surface/recessed etc. as required. (Make: Havells/ Polycab / Finolex)				
a	2 X 1.5 sq. mm + 1 X 1.5 sq. mm earth wire	7	Rmt		
b	2 x 2.5sq. mm + 1 x 2.5 sq. mm earth wire	50	Rmt		
c	2 x 4.0sq. mm + 1 x 4.0 sq. mm earth wire	220	Rmt		
d	2 x 10 sq. mm + 1 x 6 sq. mm earth wire	15	Rmt		
3	Supplying and fixing suitable size GI box with modular plate and cover in front on surface or in recess, including providing and fixing 3 pin 5/6 A modular socket outlet and 5/6 A modular switch, connections etc. as required. (Make: Anchor Roma / Havells)	21	Nos.		
4	Dismantling of wires, connections, plates & GI boxes etc and Supplying and fixing following size/ modules, GI box alongwith modular base & cover plate for modular switches in recess with complete connection etc. as required. (Make: Anchor Roma / Havells)				
a	6 Module (200mmX75mm) (1.27.4)	12	Nos.		
b	8 Module (125mmX125mm) (1.27.5)	3	Nos.		
c	12 Module (200mmX150mm) (1.27.6)	7	Nos.		
5	Supplying and fixing following modular switch/ socket on the existing modular plate & switch box including connections but excluding modular plate etc. as required (Make: Anchor Roma / Havells)				
a	5/6 A switch	52	Nos.		
b	15/16 A switch	12	Nos.		
c	3 pin 5/6 A socket outlet	19	Nos.		
d	6 pin 15/16 A socket outlet	12	Nos.		
6	Supplying and fixing two module stepped type electronic fan regulator on the existing modular plate switch box including connections but excluding modular plate etc. as required (Make: Anchor Roma / Havells)	22	Nos.		
7	Supplying and fixing suitable size GI box with modular plate and cover in front on surface or in recess, including providing and fixing 6 pin 5/6 &	9	Nos.		

	15/16 A modular socket outlet and 15/16 A modular switch, connections etc. as required. (Make: Anchor Roma / Havells)				
8	Supplying and fixing 5 A to 32 A rating, 240/415 V, 10 kA, "C" curve, miniature circuit breaker suitable for inductive load of Single poles in the existing MCB DB complete with connections, testing and commissioning etc. as required.				
a	Single Pole MCB (Make: ABB/ Hager / Havells)	24	Nos.		
9	Supplying and fixing 12way, single pole and neutral, sheet steel, MCB distribution board, 240 V, on surface/ recess, complete with tinned copper bus bar, neutral bus bar, earth bar, din bar, interconnections, powder painted including earthing etc. as required. (But without MCB/RCCB/Isolator) (Make: ABB/ Hager / Havells)	1	Nos.		
10	Supplying and fixing of 8 way (4 + 24), Double door, horizontal type three pole and neutral, sheet steel, MCB distribution board, 415 V, on surface/ recess, complete with tinned copper bus bar, neutral bus bar, earth bar, din bar, interconnections, powder painted including earthing etc. as required. (But without MCB/RCCB/Isolator). (Make: ABB/ Hager / Havells)	1	Nos.		
11	Supplying and fixing following rating, four pole, 415 V, isolator in the existing MCB DB complete with connections, testing and commissioning etc. as required. (Make: ABB/ Hager / Havells)				
a	63Amp (2.13.2)	1	No		
b	100 Amp (2.13.3)	1	No		
12	Supplying and fixing 20 A, 240 V, SPN Industrial type socket outlet, with 2 pole and earth, metal enclosed plug top alongwith 20 A "C" curve, SP, MCB, in sheet steel enclosure, on surface or in recess, with chained metal cover for the socket outlet and complete with connections, testing and commissioning etc. as required. (Make: Anchor / ABB / Havells)	1	No		
13	Laying and fixing of one number PVC insulated and PVC sheathed / XLPE power cable of 1.1 KV grade of following size on cable tray as required.				
a	Up to 35 sq. mm (clamped with 1mm thick saddle)	35	Rmt		
14	Supplying & making indoor end termination with brass compression gland & Aluminum lugs for following size of PVC insulated & PVC sheathed/ XLPE Aluminum conductor cable of 1.1 KV grade as reqd.				
a	3½ X 35 sq. mm (32mm)	2	Sets		
15	Dismantling, reinstallation, testing and commissioning of existing ceiling fan, with complete connection etc in all respect.	30	Nos.		
16	Supply of 3.5×35 sqmm XLPE Aluminum armored cable, PVC insulated 1.1KV Grade (Make: Havells/ Polycab)	40	Rmt		

17	Supplying and fixing 63A rating, double pole, 240/415 V, MCB in the existing MCB DB complete with connections, testing and commissioning etc. as required (Make: ABB/ Hager / Havells)	1	No.		
18	Supply and Fixing of 20Watt LED Batton Tube light fitting complete connection etc as required. (Make: Crompton / Havells / Philips)	48	Nos.		
19	Supply Installation, testing and commissioning of 48'' ceiling fan, high speed including wiring the down rods of 3' length with 1.5 sq. mm FRLS PVC insulated, copper conductor, single core cable etc. as required. (Make: Crompton / Havells)	3	Nos.		
20	Supply and fixing ceiling fan fastner hook	3	Nos.		
21	Dismantling of old circuit wirings, fitting fixtures and dressing of old DB etc including shifting of unused old circuits, fitting fixtures, boards, switches sockets boxes plate etc to Maintenance Store	1	Job		
	TOTAL IN WORDS			TOTAL	

(Signature & Seal of the Contractor)

Summary of Cost

<u>S.N.</u>		<u>Amount</u>
1.	Civil Works	
2.	Electrical Works	
	<u>Total</u>	

(Signature of bidder)

LAYOUT PLANS of PROPOSED

LAB & OFFICES

&

DRAWINGS

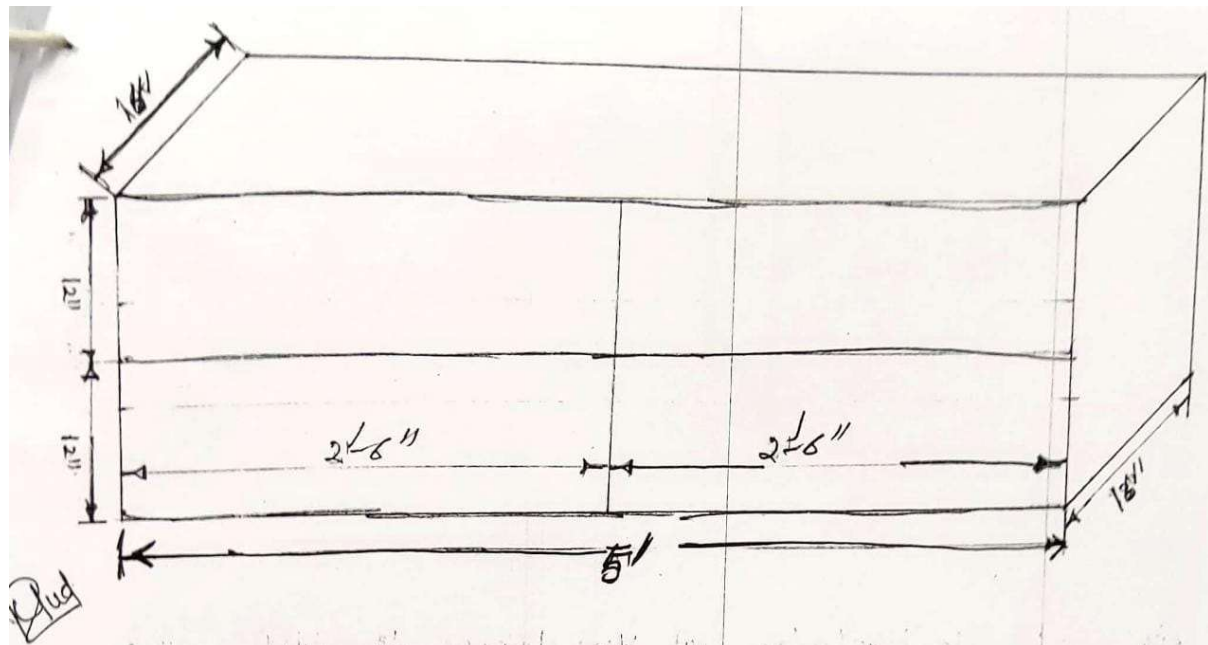

Regent of cks over the work station
 ILMU Adul's Research Lab. F/Med.

Nasem

Nasem Khan
 Assistant Engineer (Civil)
 Building & Maintenance Dept.
 Jamia Hamdard
 Hamdard Nagar, New Delhi-110062

Nasem

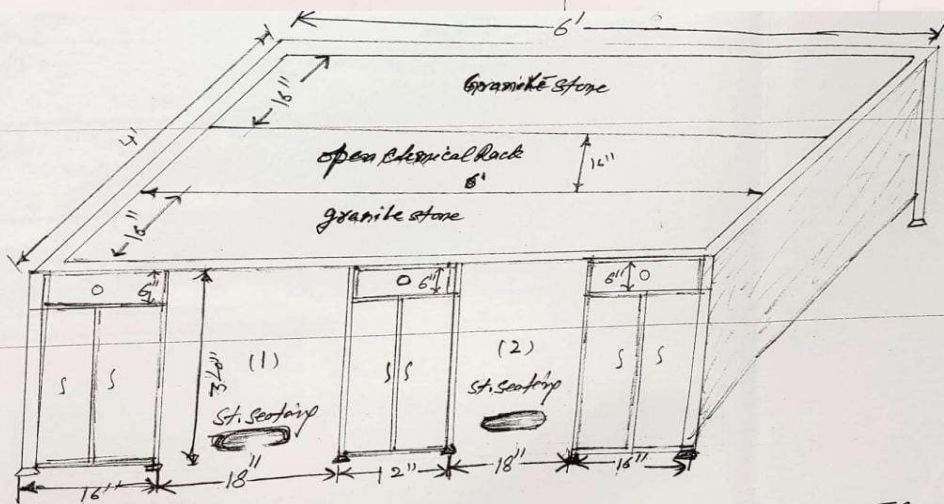

Work Station counter of Research Lab. Deptt of Ilmu Adul's
 1st floor F/Med. Jamia Hamdard.

Nasem

Nasem Khan
 Assistant Engineer (Civil)
 Building & Maintenance Dept.
 Jamia Hamdard
 Hamdard Nagar, New Delhi-110062

Nasem

Proposed Lay out plan of Research Lab & Office Deptt. of ICMU
 Patna, F/Medical, Jamia Hamdard.

